

UNITED STATES DEPARTMENT OF THE INTERIOR
NATIONAL PARK SERVICE

**NATIONAL REGISTER OF HISTORIC PLACES
INVENTORY -- NOMINATION FORM**

FOR NPS USE ONLY
RECEIVED SEP 16 1980
DATE ENTERED DEC 10 1980

SEE INSTRUCTIONS IN HOW TO COMPLETE NATIONAL REGISTER FORMS
TYPE ALL ENTRIES -- COMPLETE APPLICABLE SECTIONS

1 NAME

HISTORIC

AND/OR COMMON

CAPITOL NORTH HISTORIC DISTRICT

Roughly bounded by West 29th, and E. 24th St. Warren and Pioneer Avenues.

2 LOCATION

STREET & NUMBER

Irregular shape - roughly bounded by West 29th St. on the North; Warren Avenue on the East; West 24th St. on the South; & Pioneer on the West. All of Blocks 18,19,20,44, NOT FOR PUBLICATION

CITY, TOWN

45,46,47,78,79,80,81 & 109 Original City CONGRESSIONAL DISTRICT

CHEYENNE

VICINITY OF

STATE

WYOMING

CODE

56

COUNTY

LARAMIE

CODE

021

3 CLASSIFICATION

CATEGORY	OWNERSHIP	STATUS	PRESENT USE	
<input checked="" type="checkbox"/> DISTRICT	<input type="checkbox"/> PUBLIC	<input checked="" type="checkbox"/> OCCUPIED	<input type="checkbox"/> AGRICULTURE	<input type="checkbox"/> MUSEUM
<input type="checkbox"/> BUILDING(S)	<input type="checkbox"/> PRIVATE	<input type="checkbox"/> UNOCCUPIED	<input type="checkbox"/> COMMERCIAL	<input checked="" type="checkbox"/> PARK
<input type="checkbox"/> STRUCTURE	<input checked="" type="checkbox"/> BOTH	<input type="checkbox"/> WORK IN PROGRESS	<input type="checkbox"/> EDUCATIONAL	<input checked="" type="checkbox"/> PRIVATE RESIDENCE
<input type="checkbox"/> SITE	PUBLIC ACQUISITION	ACCESSIBLE	<input type="checkbox"/> ENTERTAINMENT	<input type="checkbox"/> RELIGIOUS
<input type="checkbox"/> OBJECT	<input type="checkbox"/> IN PROCESS	<input type="checkbox"/> YES: RESTRICTED	<input type="checkbox"/> GOVERNMENT	<input type="checkbox"/> SCIENTIFIC
	<input type="checkbox"/> BEING CONSIDERED	<input checked="" type="checkbox"/> YES: UNRESTRICTED	<input type="checkbox"/> INDUSTRIAL	<input type="checkbox"/> TRANSPORTATION
		<input type="checkbox"/> NO	<input type="checkbox"/> MILITARY	<input type="checkbox"/> OTHER:

4 OWNER OF PROPERTY

NAME

Multiple Ownership (see addendum) Item 4)

STREET & NUMBER

CITY, TOWN

CHEYENNE

VICINITY OF

STATE

WYOMING

5 LOCATION OF LEGAL DESCRIPTION

COURTHOUSE,
REGISTRY OF DEEDS, ETC.

Laramie County Assessor's Office, City-County Building

STREET & NUMBER

308 West 19th Street

CITY, TOWN

Cheyenne,

STATE

WYOMING

6 REPRESENTATION IN EXISTING SURVEYS

TITLE

CHEYENNE HISTORIC RESOURCES SURVEY

DATE

May 1979 - June 1980

FEDERAL STATE COUNTY LOCAL

DEPOSITORY FOR

SURVEY RECORDS Cheyenne-Laramie County Regional Planning Office

CITY, TOWN

Cheyenne

STATE

WYOMING

7 DESCRIPTION

CONDITION		CHECK ONE	CHECK ONE
<input checked="" type="checkbox"/> EXCELLENT	<input type="checkbox"/> DETERIORATED	<input checked="" type="checkbox"/> UNALTERED	<input checked="" type="checkbox"/> ORIGINAL SITE
<input checked="" type="checkbox"/> GOOD	<input type="checkbox"/> RUINS	<input type="checkbox"/> ALTERED	<input type="checkbox"/> MOVED DATE _____
<input type="checkbox"/> FAIR	<input type="checkbox"/> UNEXPOSED		

DESCRIBE THE PRESENT AND ORIGINAL (IF KNOWN) PHYSICAL APPEARANCE

(see addendum, Item 7)

The Capitol North District, built between 1905 - 1930 is a good blend of middle to upper class housing stock, primarily of frame construction with clapboard siding. Frame styles range from single story plains cottages to two story picturesque cottages. Several streets have brick veneer and brick construction houses in two story cottage modes and eclectic villa forms. Much of the architectural character of the district derives from the similarity of features of the properties. Design elements such as varied roof structures and imaginative massings of elements which are sometimes repeated on the same block, generate visually active street scapes. Fenestration patterns, chimney placements and design, porch locations and shapes, decorative motifs in gables, occasional stained and beveled glass ornamental windows, varieties of dormer types, and entry way ornamentation all serve to provide a rich catalog of architectural details. Uniform setbacks on most streets and developed landscaping with continuity in plantings serve to make the district cohesive.

Because of its proximity to the State Capitol and other State buildings, this district has provided housing for officials of state government including governors, state legislators, lawyers, judges, and other related professionals. In the southwest corner of the district at the corner of Pioneer and 26th Street is Gilchrist Park, dedicated by a prominent resident of the area in the early 1900's. The park, along with a memorial shaft to the east, create a mood setting corner stone for the district.

At present many home owners in the area have organized a neighborhood association intended to defend and preserve the residential character of the district. This, in reply to the increasing threat of state government expansion. Several blocks of similar housing between the districts southern boundry and the state capitol have already been violated by encroachment from new state buildings. Further impact into the district is feared.

Some significant and typical buildings contributing to the character of the district include:

- *1. The Luke Voorhees House (2819 Thomes): 1884; Picturesque Cottage, 2 stories, originally clapboarded, covered with vinyl siding, cut-out wooden soffit and frieze, one of the few remaining 19th century residences in Cheyenne. Original owner, Luke Voorhees was among the first settlers and served as Territorial and County Treasurer for 4 years and also was appointed receiver of public moneys and disbursing agent for the U.S. Land Office of Cheyenne in 1913.
- *18. The Trautwein House (2800 Carey Avenue): 1922; Italian Villa; William R. Dubois Architect; 2 stories, yellow brick, hipped roof of red tile; built for Cheyenne banker C.W. Hirsig; the Hirsig family was also among the first settlers.
- *25. Judge Guthrie's (2800 Capitol Avenue); 1922; Eclectic Villa, 1 story, red brick with wide mortar joints, hipped roof and central pavilion, open entrance patio and covered side porch. Built for contracting engineer J.B. True.
- *27. Cyrus Beard House (2710 Carey Avenue): 1911; Picturesque Cottage, 2 stories, clapboarded; variety of features including hipped roof, battered piers, flared gable, large front dormer, fish scale shingle, projecting window; Cyrus Beard, Chief Justice Wyoming State Supreme Court, occupied this house from 1915 until his death in 1921.

6 SIGNIFICANCE

PERIOD	AREAS OF SIGNIFICANCE -- CHECK AND JUSTIFY BELOW			
<input type="checkbox"/> PREHISTORIC	<input type="checkbox"/> ARCHEOLOGY-PREHISTORIC	<input type="checkbox"/> COMMUNITY PLANNING	<input type="checkbox"/> LANDSCAPE ARCHITECTURE	<input type="checkbox"/> RELIGION
<input type="checkbox"/> 1400-1499	<input type="checkbox"/> ARCHEOLOGY-HISTORIC	<input type="checkbox"/> CONSERVATION	<input type="checkbox"/> LAW	<input type="checkbox"/> SCIENCE
<input type="checkbox"/> 1500-1599	<input type="checkbox"/> AGRICULTURE	<input type="checkbox"/> ECONOMICS	<input type="checkbox"/> LITERATURE	<input type="checkbox"/> SCULPTURE
<input type="checkbox"/> 1600-1699	<input checked="" type="checkbox"/> ARCHITECTURE	<input type="checkbox"/> EDUCATION	<input type="checkbox"/> MILITARY	<input type="checkbox"/> SOCIAL/HUMANITARIAN
<input type="checkbox"/> 1700-1799	<input type="checkbox"/> ART	<input type="checkbox"/> ENGINEERING	<input type="checkbox"/> MUSIC	<input type="checkbox"/> THEATER
<input type="checkbox"/> 1800-1899	<input type="checkbox"/> COMMERCE	<input type="checkbox"/> EXPLORATION/SETTLEMENT	<input type="checkbox"/> PHILOSOPHY	<input type="checkbox"/> TRANSPORTATION
<input checked="" type="checkbox"/> 1900-	<input type="checkbox"/> COMMUNICATIONS	<input type="checkbox"/> INDUSTRY	<input checked="" type="checkbox"/> POLITICS/GOVERNMENT	<input type="checkbox"/> OTHER (SPECIFY)
		<input type="checkbox"/> INVENTION		

SPECIFIC DATES 1905 - 1930

BUILDER/ARCHITECT Various

STATEMENT OF SIGNIFICANCE

Capitol North is a well preserved but endangered middle to upper class neighborhood directly north of the Wyoming State Capitol. The districts development and evolution is a direct result of the construction of the state capitol and the expansion of government related functions. This area has provided housing for officials of state government, related professionals, and small businessmen, from approximately 1905 to present. Some significant residents include: Luke Voorhees, Territorial and State Treasurer and Laramie County Treasurer, Reciever of Public Moneys and Disbursing Agent of the U.S. Land Office 1913; Cyrus Beard, Chief Justice Wyoming State Supreme Court 1905-1920; W.E. Chaplin, Registrar U.S. Government Land Office 1911-1920; James Greenwood, Deputy Attorney General and Attorney General 1928-1934; H.R. Millard, Secretary, State Board of Sheep Commissioners 1912-1915; Leslie Miller, Governor 1933-1939; C.W. Hirsig, Vice President Citizens National Bank 1920's; Moses P. Keefe, Pioneer Contractor 1877-1929, Territorial Legislator 1886, County & City Commissioner and Mayor 1902-1903.

Although there is a variety of housing styles the district remains architecturally cohesive because of scale, uniform setbacks, the dominance of clapboarded houses and an abundance of landscaping. Regardless of house size, the residences are rich in exterior & interior architectural details because of the ready accessibility, via the railroad, of such elements from Midwestern and Eastern suppliers. Two churches within the district also demonstrate consideration of these same characteristics and blend into the character of the Neighborhood.

9 MAJOR BIBLIOGRAPHICAL REFERENCES

(see addendum, Item 9)

Wyoming State Archives - Newspaper Microfilms, Cheyenne Newspapers 1890-1979.
Wyoming State Tribune; Wyoming Eagle; Cheyenne Daily Leader; Cheyenne Tribune;
(obituaries and other articles)

Cheyenne City Directories 1887-1930

ACREAGE NOT VERIFIED

10 GEOGRAPHICAL DATA

UTM NOT VERIFIED

ACREAGE OF NOMINATED PROPERTY Approximately 20.4

QUADRANGLE NAME Cheyenne North

QUADRANGLE SCALE 1:24,000

UTM REFERENCES (see addendum, Item 10A)

A	1,3	5,1,6	7,0,0	4,5	5,4	2,5,0	B	1,3	5,1,6	8,4,0	4,5	5,4	5,6,0
	ZONE	EASTING		NORTHING			ZONE	EASTING		NORTHING			
C	1,3	5,1,5	0,3,0	4,5	5,4	4,8,0	D	1,3	5,1,5	0,8,0	4,5	5,4	5,8,0
E	1,3	5,1,5	3,8,0	4,5	5,4	4,4,0	F	1,3	5,1,5	3,2,0	4,5	5,4	3,5,0
G	1,3	5,1,5	2,3,0	4,5	5,4	3,9,0	H	1,3	5,1,5	1,3,0	4,5	5,4	2,0,0

VERBAL BOUNDARY DESCRIPTION (see addendum, Item 10)

Boundaries were chosen as a result of windshield survey, historical research and further review of the data. The age and types of housing stock change at West 29th,

LIST ALL STATES AND COUNTIES FOR PROPERTIES OVERLAPPING STATE OR COUNTY BOUNDARIES

STATE	CODE	COUNTY	CODE
STATE	CODE	COUNTY	CODE

11 FORM PREPARED BY

NAME / TITLE

JENNINGS, GOTTFRIED & CHEEK with Sheila Bricher-Wade

ORGANIZATION

Jennings, Gottfried, Cheek Preservationists.

DATE

March 1980

STREET & NUMBER

Route 5, Box 1890

TELEPHONE

405-377-6399

CITY OR TOWN

Stillwater

STATE

Oklahoma 74074

12 STATE HISTORIC PRESERVATION OFFICER CERTIFICATION

THE EVALUATED SIGNIFICANCE OF THIS PROPERTY WITHIN THE STATE IS:

NATIONAL

STATE

LOCAL

(SEE 12/8/80 PHONE REPORT)

As the designated State Historic Preservation Officer for the National Historic Preservation Act of 1966 (Public Law 89-665), I hereby nominate this property for inclusion in the National Register and certify that it has been evaluated according to the criteria and procedures set forth by the National Park Service.

STATE HISTORIC PRESERVATION OFFICER SIGNATURE

Jan Carlson

TITLE State Historic Preservation Officer

DATE August 4, 1980

FOR NPS USE ONLY

I HEREBY CERTIFY THAT THIS PROPERTY IS INCLUDED IN THE NATIONAL REGISTER

Jan Carlson
KEEPER OF THE NATIONAL REGISTER

DATE 12/10/80

ATTEST:

CHIEF OF REGISTRATION

DATE

UNITED STATES DEPARTMENT OF THE INTERIOR
NATIONAL PARK SERVICE

**NATIONAL REGISTER OF HISTORIC PLACES
INVENTORY -- NOMINATION FORM**

FOR NPS USE ONLY	
RECEIVED	SEP 16 1980
DATE ENTERED	10

CONTINUATION SHEET

ITEM NUMBER 4

PAGE one

Ownership of Structures in the Capitol North Historic District

Block 20, Original City of Cheyenne.

- *1. Luke Voorhees House, 2819 Thomes Avenue
W 20' of N 88' of Lot 3 & N 88' of Lot 4.

G. L. Smith, et ux
2819 Thomes Avenue.
Cheyenne, Wyoming 82001

2. 415 - 417 W. 29th Street
W 4' of S 66' of Lot 2, E 10' of S 44' of Lot 3, &
E 46' of N 88' of Lot 3.

Keith M. Miller, et ux
1856 Converse
Cheyenne, Wyoming 82001

3. 2820 Pioneer Avenue
N $\frac{1}{2}$ of Lots 1 & 2.

George Jensen, et ux
2820 Pioneer Avenue
Cheyenne, Wyoming 82001

4. 2814 Pioneer Avenue
S $\frac{1}{2}$ of Lot 1, E 62' of S $\frac{1}{2}$ of Lot 2.

Peter J. Marron
2814 Pioneer Avenue
Cheyenne, Wyoming 82001

5. 2815 Thomes Avenue
W 56' of S 44' of Lot 3 & S 44' of Lot 4

Raymond D. Kisicki, et ux
2815 Thomes Avenue
Cheyenne, Wyoming 82001

6. 420 W. 28th Street
All of Lot 5

John J. Rooney, et ux
420 W. 28th Street
Cheyenne, Wyoming

UNITED STATES DEPARTMENT OF THE INTERIOR
NATIONAL PARK SERVICE

**NATIONAL REGISTER OF HISTORIC PLACES
INVENTORY -- NOMINATION FORM**

FOR NPS USE ONLY
RECEIVED SEP 15 1980
DATE ENTERED

CONTINUATION SHEET

ITEM NUMBER 4

PAGE TWO

Ownership of Structures in the Capitol North Historic District

Block 20, Original City of Cheyenne (continued)

7. 416 W. 28th Street
W 44' of Lot 6.

Dewey Ruble Jr., et ux
416 W. 28th Street

8. 410 W. 28th Street
E 22' of Lot 6 & W 22' of Lot 7.

Agnes M. Baucom
410 W. 28th Street
Cheyenne, Wyoming 82001

9. 406 W. 28th Street
E 44' of Lot 7.

George S. Toly, Et ux.
406 W. 28th Street
Cheyenne, Wyoming

10. 402 W. 28th Street
All of Lot 8.

David W. Smallwood, et ux
402 W. 28th Street
Cheyenne, Wyoming 82001

Block 19, Original City of Cheyenne

11. 2821 Pioneer Avenue
N 44' of Lots 3 & 4.

Kenneth J. Berg, et ux
2821 Pioneer Avenue
Cheyenne, Wyoming 82001

12. 2822 Carey Avenue
N 49' of Lots 1 & 2

Ruth V. Foresman, et al
2822 Carey Avenue
Cheyenne, Wyoming 82001

UNITED STATES DEPARTMENT OF THE INTERIOR
NATIONAL PARK SERVICE

**NATIONAL REGISTER OF HISTORIC PLACES
INVENTORY -- NOMINATION FORM**

FOR NPS USE ONLY
RECEIVED
DATE ENTERED

CONTINUATION SHEET

ITEM NUMBER 4

PAGE three

Ownership of Structures in the Capitol North Historic District

Block 19, Original City of Cheyenne (continued)

13. 2814 Carey Avenue
S 83' of Lots 1 & 2.

H. W. Read
P. O. Box 733
Cheyenne, Wyoming 82001
14. 2817 Pioneer Avenue
S 44' of N 88' of Lots 3 & 4.

Lenora H. Walker, et ux
2817 Pioneer Avenue
Cheyenne, Wyoming
15. 2813 Pioneer Avenue
S 44' of Lots 3 & 4.

Irene R. Hess
2813 Pioneer Avenue
Cheyenne, Wyoming 82001
16. 322 W. 28th Street
All of Lot 5.

Thomas D. Newman
321 E. 18th Street
Cheyenne, Wyoming
17. 320 W. 28th
All of Lot 6.

David Mullen, et ux
320 W. 28th Street
Cheyenne, Wyoming
- *18. Trautwein House, 2800 Carey Avenue
All of Lots 7 & 8.

Peter W. Cook
2800 Carey Avenue
Cheyenne, Wyoming 82001

UNITED STATES DEPARTMENT OF THE INTERIOR
NATIONAL PARK SERVICE

**NATIONAL REGISTER OF HISTORIC PLACES
INVENTORY -- NOMINATION FORM**

FOR NPS USE ONLY	
RECEIVED	1981
DATE ENTERED	10

CONTINUATION SHEET

ITEM NUMBER 4

PAGE four

Ownership of Structures in the Capitol North Historic District

Block 18, Original City of Cheyenne.

19. 2821 Carey Avenue
N $\frac{1}{2}$ of Lots 3 & 4.

Georgette Silverblatt
2821 Carey Avenue
Cheyenne, Wyoming
20. 2822 Capitol
N 66' of Lots 1 & 2.

James L. Appelgate, et ux
2822 Capitol
Cheyenne, Wyoming 82001
21. 2814 Capitol
S 66' of Lots 1 & 2.

Rodney M. Guthrie, et ux
2814 Capitol
Cheyenne, Wyoming 82001
22. 2815 Carey Avenue
S $\frac{1}{2}$ of Lots 3 & 4.

Janney Rodrick, et ux
2815 Carey Avenue
Cheyenne, Wyoming 82001
23. 2809 Carey Avenue
N 66' of Lot 5, N 66' of W 62' of Lot 6.

Richard W. Johnston, et ux
2809 Carey Avenue
Cheyenne, Wyoming 82001
24. 2803 Carey Avenue
S 66' of Lots 5 & 6, E 4' of N 66' of Lot 6.

Robert J. Connaghan, et ux
2803 Carey Avenue
Cheyenne, Wyoming 82001

UNITED STATES DEPARTMENT OF THE INTERIOR
NATIONAL PARK SERVICE

**NATIONAL REGISTER OF HISTORIC PLACES
INVENTORY -- NOMINATION FORM**

FOR NPS USE ONLY
RECEIVED SEP 16 1980
DATE ENTERED

CONTINUATION SHEET

ITEM NUMBER 4

PAGE five

Ownership of Structures in the Capitol North Historic District

Block 18, Original City of Cheyenne (continued)

- *25. Judge Guthries House, 2800 Capitol
All of Lots 7 & 8.

Rodney M. Guthrie, et ux
2800 Capitol
Cheyenne, Wyoming 82001

Block 44, Original City of Cheyenne

26. 2722 Carey Avenue
All of Lots 1,2,3 & 4.

Walter J. Stamy, et ux
P.O. Box 2147
Cheyenne, Wyoming 82001

- *27. Cyrus Beard House, 2710 Carey Avenue
N $\frac{1}{2}$ of Lots 7 & 8.

James R. Marshall, et ux
2710 Carey Avenue
Cheyenne, Wyoming 82001

28. 2700 Carey Avenue
S $\frac{1}{2}$ of Lots 7 & 8.

Charles A. Koch, et ux
2700 Carey Avenue
Cheyenne, Wyoming 82001

29. 2701 Pioneer Avenue
All of Lots 5 & 6

George Andrews
Rt. 3, Box 491 A
Cheyenne, Wyoming 82001

UNITED STATES DEPARTMENT OF THE INTERIOR
NATIONAL PARK SERVICE

**NATIONAL REGISTER OF HISTORIC PLACES
INVENTORY -- NOMINATION FORM**

FOR NPS USE ONLY
RECEIVED SEP 16 1980
DATE ENTERED

CONTINUATION SHEET

ITEM NUMBER 4 PAGE six

Ownership of Structures in the Capitol North Historic District

Block 45, Original City of Cheyenne.

30. 2717 Carey Avenue
W 16' of Lot 3, All of Lot 4.

Bert McGee
c/o A.B. Neiss
P.O. Box 187
Cheyenne, Wyoming 82001

31. 215 W. 28th Street
E. 50' of Lot 3.

Vernon E. Almich, et ux
215 W. 28th Street
Cheyenne, Wyoming 82001

32. 2720 Capitol Avenue
All of Lots 1 & 2.

Patricia B. Hays
2720 Capitol Avenue
Cheyenne, Wyoming 82001

33. 202 W. 27th Street
All of Lot 8.

Bradford R. Howard, et ux
202 W. 27th Street
Cheyenne, Wyoming 82001

- *34. Moses P. Keefe House, 210 W. 27th Street
E 6' of Lot 6 & all of Lot 7.

William E. Barnes, et ux
210 W. 27th Street
Cheyenne, Wyoming

35. 216 W. 27th Street
W 50' of E 56' of Lot 6.

Grant C. Harris, et ux
216 W. 27th Street
Cheyenne, Wyoming 82001

UNITED STATES DEPARTMENT OF THE INTERIOR
NATIONAL PARK SERVICE

**NATIONAL REGISTER OF HISTORIC PLACES
INVENTORY -- NOMINATION FORM**

FOR NPS USE ONLY

RECEIVED

DATE ENTERED

CONTINUATION SHEET

ITEM NUMBER 4 PAGE seven

Ownership of Structures in the Capitol North Historic District

Block 45, Original City of Cheyenne (continued)

36. 220 W. 27th Street
W 10' of Lot 6, all of Lot 5.

James E. Cowan, et ux
220 W. 27th Street
Cheyenne, Wyoming 82001

Block 46, Original City of Cheyenne

37. 2721 Capitol Avenue
W 5' of N 44' of Lot 2, N 44' of Lots 3 & 4.

Harley A. Henderson, et al
2721 Capitol Avenue
Cheyenne, Wyoming 82001

38. 2722 Central Avenue
N44' of Lot 1, N 44' of E 61' of Lot 2.

Rick D. Hunnicutt, et ux
2722 Central Avenue
Cheyenne, Wyoming 82001

39. 2718 Central Avenue
S 44' of N 88' of Lot 1, S 44' of N 88' of E 61' of Lot 2.

Charles W. Hanscum
2718 Central Avenue
Cheyenne, Wyoming 82001

40. 2719 Capitol Avenue
W 5' of N 44' of S 88' of Lot 2, N 44' of S88' of Lots 3 & 4.

Sheldon R. Wood
2719 Capitol Avenue
Cheyenne, Wyoming 82001

UNITED STATES DEPARTMENT OF THE INTERIOR
NATIONAL PARK SERVICE

**NATIONAL REGISTER OF HISTORIC PLACES
INVENTORY -- NOMINATION FORM**

FOR NPS USE ONLY
RECEIVED SEP 16 1980
DATE ENTERED

CONTINUATION SHEET

ITEM NUMBER 4

PAGE eight

Ownership of Structures in the Capitol North Historic District

Block 46, Original City of Cheyenne (continued)

41. 2715 Capitol Avenue
W 5' of S 44' of Lot 2, S 44' of Lots 3 & 4.

Lois E. Tyler
2715 Capitol Avenue
Cheyenne, Wyoming 82001
42. 2714 Central Avenue
S 44' of Lot 1, S 44' of E 61' of Lot 2.

Christian P. Mai, et ux
2714 Central Avenue
Cheyenne, Wyoming 82001
43. 102 W. 27th Street
All of Lot 8.

Faye Alexander
102 W. 27th Street
Cheyenne, Wyoming 82001
- *44. Governor Leslie Miller House, 108 W. 27th Street
All of Lot 7.

Marion Bolsel
108 W. 27th Street
Cheyenne, Wyoming 82001
45. 114 W. 27th Street
All of Lot 6.

William G. Martin
c/o Dick Reid, et ux
114 W. 27th Street
Cheyenne, Wyoming 82001
46. 122 W. 27th Street
All of Lot 5.

James S. Lambert, et ux
122 W. 27th Street
Cheyenne, Wyoming 82001

UNITED STATES DEPARTMENT OF THE INTERIOR
NATIONAL PARK SERVICE

**NATIONAL REGISTER OF HISTORIC PLACES
INVENTORY -- NOMINATION FORM**

FOR NPS USE ONLY
RECEIVED SEP 10 1980
DATE ENTERED

CONTINUATION SHEET

ITEM NUMBER 4 PAGE nine

Ownership of Structures in the Capitol North Historic District

Block 47, Original City of Cheyenne

47. 2723 Central Avenue
N 44' of Lots 3 & 4.
- Eugene R. Bailey, et al
P.O. Box 211
Cheyenne, Wyoming 82001
48. 2722 Warren Avenue
N44' of Lots 1 & 2 .
- Earl C. Rice, et ux
2722 Warren Avenue
Cheyenne, Wyoming 82001
49. 2716 Warren Avenue
E 127' of S 44' of N 88' of Lots 1 & 2.
- Robert D. Laybourn
2716 Warren Avenue
Cheyenne, Wyoming 82001
50. 2719 Central Avenue
N 44' of S 88' Lots 3 & 4.
- Ruth Shuman
2719 Central Avenue
Cheyenne, Wyoming 82001
51. 2715 Central Avenue
S 44' of Lots 3 & 4.
- Clifford A. Martin
2715 Central Avenue
Cheyenne, Wyoming 82001
52. 2714 Warren Avenue
S 44' of Lot 1 & S 44' of Lot 2.
- Phyllis K. Stimpert, et al
2714 Warren Avenue
Cheyenne, Wyoming 82001

UNITED STATES DEPARTMENT OF THE INTERIOR
NATIONAL PARK SERVICE

FOR NPS USE ONLY
RECEIVED
DATE ENTERED

**NATIONAL REGISTER OF HISTORIC PLACES
INVENTORY -- NOMINATION FORM**

CONTINUATION SHEET

ITEM NUMBER 4

PAGE ten

Ownership of Structures in the Capitol North Historic District

Block 47, Original City of Cheyenne (continued)

53. 2712 Warren Avenue
N 42' of E 44' of Lot 8.

Elaine Travis (Ungericht)
2712 Warren Avenue
Cheyenne, Wyoming 82001

54. 122 E. 27th Street
S 90' of E 44' of Lot 8.

c/o First National Bank of Wheatland
Drawer 669
Wheatland, Wyoming

55. 116 E. 27th Street
E 22' of Lot 7, E 22' of Lot 8.

Danny G. Hicks
116 E. 27th Street
Cheyenne, Wyoming 82001

56. 110 E. 27th Street
W 44' of Lot 7.

Mary H. Rhode Trustee
P.O. Box 503
Cheyenne, Wyoming 82001

57. 108 E. 27th Street
E 44' of Lot 6.

Agnes L. Long
108 E. 27th Street
Cheyenne, Wyoming 82001

58. 106 E. 27th Street
E 22' of Lot 5, W 22' of Lot 6.

David A. Finley, et ux
106 E. 27th Street
Cheyenne, Wyoming 82001

UNITED STATES DEPARTMENT OF THE INTERIOR
NATIONAL PARK SERVICE

FOR NPS USE ONLY
RECEIVED SEP 16 1980
DATE ENTERED

**NATIONAL REGISTER OF HISTORIC PLACES
INVENTORY -- NOMINATION FORM**

CONTINUATION SHEET

ITEM NUMBER 4 PAGE eleven

Ownership of Structures in the Capitol North Historic District

Block 47, Original City of Cheyenne (continued)

59. 100 E. 27th Street
W 44' of Lot 5.

Arthur J. LaCroix III, et ux
100 E. 27th Street
Cheyenne, Wyoming 82001

Block 81, Original City of Cheyenne

60. 314 Randall Avenue (G & R Service Center)
Fraction, nearly all of Lot 3, N fraction (about $\frac{1}{2}$) of Lot 4.
(see also item # 63)

Josephine Theresa Forister
c/o Continental Oil Company
Ponca City, Oklahoma

c/o Melvin Straub
Randall Station
314 Randall Avenue
Cheyenne, Wyoming 82001

61. ~~2622 Central Avenue.~~
N $\frac{1}{2}$ of Lots 1 & 2.

Kathryn J. Schaffer, et al
2622 Carey Avenue
Cheyenne, Wyoming 82001

62. 2616 Carey Avenue
S $\frac{1}{2}$ of Lots 1 & 2.

Frank McQue Trustee
c/o First National Bank & Trust
Trustee
P.O. Box 1768
Cheyenne, Wyoming 82001

63. 312 Randall Avenue (Pinon Tree Cafe)
Fraction, nearly all of Lot 3, N fraction (about $\frac{1}{2}$) of Lot 4.
(see also item # 60)

UNITED STATES DEPARTMENT OF THE INTERIOR
NATIONAL PARK SERVICE

FOR NPS USE ONLY
RECEIVED SEP 15 1981
DATE ENTERED 9-10

**NATIONAL REGISTER OF HISTORIC PLACES
INVENTORY -- NOMINATION FORM**

CONTINUATION SHEET

ITEM NUMBER 4 PAGE twelve

Ownership of Structures in the Capitol North Historic District

Block 81, Original City of Cheyenne (continued)

63. (continued)
Josephine Theresa Forister
c/o Continental Oil Company
Ponca City, Oklahoma
- c/o Melvin Straub
Randall Station
312 Randall Avenue
Cheyenne, Wyoming 82001
64. 310 Randall Avenue
Portion of Lots 6 & 7 N of Randall.
- Arlene Amanon
310 Randall Avenue
Cheyenne, Wyoming 82001
65. 300 W. 26th Street
All of Lot 8.
- Faye Friedman
P.O. Box 682
Cheyenne, Wyoming 82001

Block 80, Original City of Cheyenne

66. 219 W. 27th Street
All of Lots 3 & 4. & N $\frac{1}{2}$, Lot 1, & E. 6', N $\frac{1}{2}$, Lot 2.
- First Christian Church
219 W. 27th Street
Cheyenne, Wyoming 82001
67. 215 W. 27th Street
W 60' of N $\frac{1}{2}$ of Lot 2
- Helen Olds
215 W. 27th Street
Cheyenne, Wyoming 82001

UNITED STATES DEPARTMENT OF THE INTERIOR
NATIONAL PARK SERVICE

FOR NPS USE ONLY	
RECEIVED	SEP 10 1981
DATE ENTERED	SEP 10

**NATIONAL REGISTER OF HISTORIC PLACES
INVENTORY -- NOMINATION FORM**

CONTINUATION SHEET

ITEM NUMBER 4 PAGE thirteen

Ownership of Structures in the Capitol North Historic District

Block 80, Original City of Cheyenne (continued)

68. 2614 Capitol Avenue
S $\frac{1}{2}$ of Lots 1 & 2.

Geraldine E. Gobruegge
c/o Martha K. Homblin
13206 Hartsook St.
Sherman Oakes, CA 91403

69. 2611 Carey Avenue
N 40' of Lot 5.

Louis L. Schott
2611 Carey Avenue
Cheyenne, Wyoming 82001

70. 220 W. 26th Street
S 92' of Lot 5.

Charles W. Vaughn, et ux
3210 Snyder Avenue
Cheyenne, Wyoming 82001

71. 218 W. 26th Street
All of Lot 6.

Mark Kelly
c/o Allan E. Brinkman, et ux
Cheyenne, Wyoming 82001

- *72. A. A. Underwood House, 214 W. 26th Street
All of Lots 7 & 8.

Lily C. Underwood
214 W. 26th Street
Cheyenne, Wyoming 82001

UNITED STATES DEPARTMENT OF THE INTERIOR
NATIONAL PARK SERVICE

FOR NPS USE ONLY

RECEIVED SEP 16 1980

DATE ENTERED

**NATIONAL REGISTER OF HISTORIC PLACES
INVENTORY -- NOMINATION FORM**

CONTINUATION SHEET

ITEM NUMBER 4 PAGE fourteen

Ownership of Structures in the Capitol North Historic District

Block 79, Original City of Cheyenne.

73. 123 W. 27th Street
N 70' 8" of Lot 4.

Horace L. Fox, et ux
123 W. 27th Street
Cheyenne, Wyoming 82001
74. 115 W. 27th Street
All of Lot 3.

Fred H. Blume
c/o Charles H. Cantine
P.O. Box 1683
Cheyenne, Wyoming 82001
- *75. W.E. Chaplin House (2622 Central)
N 44' of Lots 1 & 2.

Ross V. Howard, et ux
2622 Central
Cheyenne, Wyoming 82001
76. 2616 Central Avenue
N 44' of S 88' of Lots 1 & 2.

Betty J. Falwell
2616 Central Avenue
Cheyenne, Wyoming 82001
- *77. D. S. Swan House, 2612 Central Avenue
S 44' of Lots 1 & 2.

Virginia Carlisle
2612 Central Avenue
Cheyenne, Wyoming 82001
78. 2615 Capitol Avenue
S 61' 4" of Lot 4.

Ada L. Colby
2615 Capitol Avenue
Cheyenne, Wyoming 82001

UNITED STATES DEPARTMENT OF THE INTERIOR
NATIONAL PARK SERVICE

FOR NPS USE ONLY	
RECEIVED	SEP 16 1980
DATE ENTERED	

**NATIONAL REGISTER OF HISTORIC PLACES
INVENTORY -- NOMINATION FORM**

CONTINUATION SHEET

ITEM NUMBER 4 PAGE fifteen

Ownership of Structures in the Capitol North Historic District

Block 79, Original City of Cheyenne (continued)

79. 2610 Central Avenue
N 34' of E 20' of Lot 7, N 34' of Lot 8.

Louis A Cruz
2610 Central Avenue
Cheyenne, Wyoming 8s001

80. 2608 Central Avenue
S 33' of N 67' of E 20' of Lot 7, S 36' of N 70' of E 60' of
Lot 8, S 33' of N 67' of W 6' of Lot 8.

Doris J. Eichenour
c/o Robert Townsend
1916 Logan Avenue

81. 102 W. 26th Street
E 50' of S 62' of Lot 8.

The Foundation of the Twelve Apostles
P.O. Box 788
Cheyenne, Wyoming 82001

82. 104 W 26th Street
S 65' of E 28' of Lot 7, S 62' of E 10' of W 16' of Lot 8,
S 65' of W 6' of Lot 8.

Michael G. Pearson
c/o J.D. Sewell Jr.
6539 Moreland Avenue
Cheyenne, Wyoming 82001

83. 106 W. 26th Street
N 56' of W 36' of Lot 7, S 76' of W 38' of Lot 7.

Velda M. Martin
106 W. 26th Street
Cheyenne, Wyoming 82001

84. 118 W. 26th Street
E 44' of Lot 6

Robert A. Greenlee, et ux
118 W. 26th Street
Cheyenne, Wyoming 82001

UNITED STATES DEPARTMENT OF THE INTERIOR
NATIONAL PARK SERVICE

FOR NPS USE ONLY
RECEIVED SEP 14 1980
DATE ENTERED

**NATIONAL REGISTER OF HISTORIC PLACES
INVENTORY -- NOMINATION FORM**

CONTINUATION SHEET

ITEM NUMBER 4 PAGE sixteen

Ownership of Structures in the Capitol North Historic District

Block 79, Original City of Cheyenne (continued)

85. 120 W. 26th Street
E 22' of Lot 5, W 22' of Lot 6.

Alfred A. Trudell, et ux
120 W. 26th Street
Cheyenne, Wyoming 82001

86. 122 W. 26th Street
W 44' of Lot 5.

Merle Johnson, et ux
122 W. 26th Street
Cheyenne, Wyoming 82001

Block 78, Original City of Cheyenne

87. 2623 Central Avenue
N 44' of Lots 3 & 4.

Jessie R. Sorensen
3420 Capitol Avenue Trustee
c/o Raymond J. Shawke
2623 Central Avenue
Cheyenne, Wyoming 82001

88. 2622 Warren Avenue
N 44' of Lots 1 & 2.

John F. Vance, et ux
2622 Warren Avenue
Cheyenne, Wyoming 82001

89. 2618 Warren Avenue
S 44' of N 88' of Lots 1 & 2.

Allen C. Johnson
2618 Warren Avenue
Cheyenne, Wyoming 82001

90. 2619 Central Avenue
W 127' of N 44' of Lots 3 & 4.

UNITED STATES DEPARTMENT OF THE INTERIOR
NATIONAL PARK SERVICE

FOR NPS USE ONLY
RECEIVED
DATE ENTERED

**NATIONAL REGISTER OF HISTORIC PLACES
INVENTORY -- NOMINATION FORM**

CONTINUATION SHEET

ITEM NUMBER 4 PAGE seventeen

Ownership of Structures in the Capitol North Historic District

Block 78, Original City of Cheyenne (continued)

90. (continued)
Jeremy B. Wight, et ux
2619 Central Avenue
Cheyenne, Wyoming 82001
91. 2615 Central Avenue
S 44' of Lots 3 & 4.

Robert Lee Coomes
2615 Central Avenue
Cheyenne, Wyoming 82001
92. 2614 Warren Avenue
S 44' of Lots 1 & 2.

Patricia A. Gavagan
2614 Warren Avenue
Cheyenne, Wyoming 82001
93. 2610 Warren Avenue
E 44' of Lot 8.

Joseph E. Mohatt Jr.
208 E. 3rd Avenue
Cheyenne, Wyoming 82001
94. 122 E. 26th Street
E 44' of Lot 8.

Joseph E. Mohatt Jr.
208 E. 3rd Avenue
Cheyenne, Wyoming 82001
95. 120 E. 26th Street
E 22' of Lot 7, W 22' of Lot 8.

Robert M. Mohatt
208 E. 3rd Avenue
Cheyenne, Wyoming 82001
96. 116 E 26th Street
W 44' of Lot 7.

UNITED STATES DEPARTMENT OF THE INTERIOR
NATIONAL PARK SERVICE

FOR NPS USE ONLY
RECEIVED SEP 16 1980
DATE ENTERED

**NATIONAL REGISTER OF HISTORIC PLACES
INVENTORY -- NOMINATION FORM**

CONTINUATION SHEET

ITEM NUMBER 4 PAGE eighteen

Ownership of Structures in the Capitol North Historic District

Block 78, Original City of Cheyenne (continued)

96. (continued)

Keith K. Shreve
116 E 26th Street
Cheyenne, Wyoming 82001

97. 110 E 26th Street
E 44' of Lot 6.

David H. Wilson, et ux
110 E 26th Street
Cheyenne, Wyoming 82001

98. 104 E 26th Street
E 22' of Lot 5, W 22' of Lot 6.

Everett L. Scofield, et ux
104 E 26th Street
Cheyenne, Wyoming 82001

99. 100 E 26th Street (VanSchaak Realty)
W 44' of Lot 5.

Nicholas Dudash, et ux
920 Ridgeland
Cheyenne, Wyoming 82001

Block 109, Original City of Cheyenne (continued)

100. 2521 Central Avenue
N 66' of Lot 4, W 17' of N 66' of Lot 3.

Marvin P. Gertsch Jr.
400 Lafayette Blvd.
Cheyenne, Wyoming 82001

101. 111-113 E 26th Street
E 49' of N 66' of Lot 3.

Nora M. O'Donnell
2410 Pioneer Avenue
Cheyenne, Wyoming 82001

UNITED STATES DEPARTMENT OF THE INTERIOR
NATIONAL PARK SERVICE

FOR NPS USE ONLY
RECEIVED SEP 18 1980
DATE ENTERED

**NATIONAL REGISTER OF HISTORIC PLACES
INVENTORY -- NOMINATION FORM**

CONTINUATION SHEET

ITEM NUMBER 4 PAGE nineteen

Ownership of Structures in the Capitol North Historic District

Block 109, Original City of Cheyenne (continued)

102. 115-117 E 26th Street
N $\frac{1}{2}$ of Lot 2.

Don B. Hawes
1204 E. Pershing
Cheyenne, Wyoming 82001
- *103. Jas Greenwood House, 2522 Warren Avenue
N $\frac{1}{2}$ of Lot 1.

George R. Law, et ux
2522 Warren Avenue
Cheyenne, Wyoming 82001
104. 2518 Warren Avenue
N 35' 6" of S $\frac{1}{2}$ of Lots 1 & 2.

Don B. Hawes
1204 E Pershing
Cheyenne, Wyoming 82001
105. 2515 Central
S $\frac{1}{2}$ of Lots 3 & 4.

Jack A. Millyard
2515 Central
Cheyenne, Wyoming 82001
106. 2514 Warren Avenue
S 30' 6" Lots 1 & 2.

Martha Alex
2514 Warren Avenue
Cheyenne, Wyoming 82001
107. 2510 Warren Avenue
N 34' of E 56' of Lot 7, N 34' of Lot 8.

Bernard R. Pitts, et ux
2510 Warren Avenue
Cheyenne, Wyoming 82001

UNITED STATES DEPARTMENT OF THE INTERIOR
NATIONAL PARK SERVICE

FOR NPS USE ONLY
RECEIVED
DATE ENTERED

**NATIONAL REGISTER OF HISTORIC PLACES
INVENTORY -- NOMINATION FORM**

CONTINUATION SHEET

ITEM NUMBER 4 PAGE twenty

Ownership of Structures in the Capitol North Historic District

Block 109, Original City of Cheyenne (continued)

108. 2511 Central Avenue
N 44' of Lot 5.

Christopher J. Person
2511 Central Avenue
Cheyenne, Wyoming 82001

*109. Kathryn Maness House, 2507 Central
N 44' of S 88' of Lot 5.

Kathryn Maness, et ux
2505 Central Avenue
Cheyenne, Wyoming 82001

110 2508 Warren Avenue
W 10' of N 34' of Lot 7, S 32' of N $\frac{1}{2}$ of Lots 7 & 8.

Idabelle Ducker
2508 Warren Avenue
Cheyenne, Wyoming 82001

111. 122 E 25th Street
S $\frac{1}{2}$ of Lot 8.

Mary A. Brock
122 E 25th Street
Cheyenne, Wyoming 82001

112. 108-110- E 25th Street
S $\frac{1}{2}$ of Lot 7.

Robert R. Laybourn, et ux
2716 Warren Avenue
Cheyenne, Wyoming 82001

113. 106 E 25th Street
E 33' of Lot 6.

Vera L. Whitters
106 E 25th Street
Cheyenne, Wyoming 82001

UNITED STATES DEPARTMENT OF THE INTERIOR
NATIONAL PARK SERVICE

**NATIONAL REGISTER OF HISTORIC PLACES
INVENTORY -- NOMINATION FORM**

FOR NPS USE ONLY
RECEIVED
DATE ENTERED

CONTINUATION SHEET

ITEM NUMBER 4

PAGE twenty-one

Ownership of Structures in the Capitol North Historic District

Block 109, Original City of Cheyenne

114. 104 E 25th Street
W 33' of Lot 6.

Phillip P. O'Brien, et ux
104 E 25th Street
Cheyenne, Wyoming 82001

115. 2505 Central Avenue
S 44' of Lot 5.

Doyle Maness
2505 Central Avenue
Cheyenne , Wyoming 82001

UNITED STATES DEPARTMENT OF THE INTERIOR
NATIONAL PARK SERVICE

FOR NPS USE ONLY	
RECEIVED	SEP 16 1980
DATE ENTERED	

**NATIONAL REGISTER OF HISTORIC PLACES
INVENTORY -- NOMINATION FORM**

CONTINUATION SHEET

ITEM NUMBER 7 PAGE twenty-two

- *34. Moses P. Keefe House (210 West 27th): 1910; Eclectic Cottage; Moses P. Keefe, designer; 1½ stories, clapboarded, stone foundation, enclosed porch with Tuscan columns and pedimented temple front, 2 gabled dormers, and tower. Constructed by Moses Keefe, a prominent Cheyenne contractor involved in construction of Fort Russell, the State Capitol additions, many Cheyenne residences, schools, and churches. The Keefe family owned and occupied the home until 1975.
- *44. Governor Leslie Miller Home (108 W. 27th): 1908; Picturesque Cottage, 2 stories, clapboarded covered with vinyl siding, enclosed porch with undecorated pilasters, and frieze. Second story windows 6 over 1 pattern with pattern reflected in dormer windows and porch, roof hipped and flared on dormer, porch and house. Simplified classical details. Although the governor's mansion had been completed by the time Governor Miller took office he chose to remain in this house throughout his term.
- *75. W.E. Chaplin House (2622 Central): 1910; Plains Cottage, 2 stories, red brick with more classical details than usual, string course of brick and corners quoined with entablature, porch trimmed in sandstone with segmental arches (for drainage) and sandstone sill, hipped dormer and hipped roof. Built for W.E. Chaplin, Registrar for U.S. Land Office in 1913. Mr. Chaplin later became a noted editor in Laramie, Wyoming and a respected Wyoming author.
- *72. A.A. Underwood House (214 W. 26th) 1905; Plains House, 2 stories, clapboarded on first floor and shingle on second, intersecting gable roof with clipped gable on east, stained glass in upper ½ of windows, stone foundation, upper story wall flared, with fishscale in front gable. Originally this house was constructed for A. A. Underwood a foreman whose family has owned and operated small businesses in Cheyenne since the 1880's. The Underwood family still lives in the house.
- *77. D. S. Swan House (2612 Central Avenue) 1915; Plains Cottage, 1½ stories, clapboarded, 2 hipped dormers with shingles, hipped roof with large overhang, wing walls flared at base. Original owner D.S. Swan a prominent Cheyenne business man who started the first electric light company in Cheyenne, one of the first in the West.
- *103. James Greenwood House (2522 Warren Avenue) 1910; Plains Cottage, 2 story, asphalt siding, clipped gabled roof, slight overhand, occasional gable over windows which functions as a hood, original stained glass in upper ½ of front window & transom. A nice composition of elements to make it vertical. Mr Greenwood served as Deputy Attorney General and later as Attorney General in the 1930's.
- *109. Kathryn Menass House (2507 Central Avenue) 1908; Plains House, 1 story, clapboarded, gabled roof with fishscale shingle in the gable, entrance porch with Tuscan columns, wooden entablature and mansard roof which butts into gable. This house is one of many in the district which demonstrate the transition from the simple plains house to the cottage style, and housed many middle income families.

UNITED STATES DEPARTMENT OF THE INTERIOR
NATIONAL PARK SERVICE

FOR NPS USE ONLY	
RECEIVED	SEP 16 1980
DATE ENTERED	SEP 10 1980

**NATIONAL REGISTER OF HISTORIC PLACES
INVENTORY -- NOMINATION FORM**

CONTINUATION SHEET

ITEM NUMBER 7 PAGE twenty-three

INTRUSIONS IN THE CAPITOL NORTH HISTORIC DISTRICT

60. G & R Service Center - a converted 1960's Gas Station of concrete block construction. This building is brightly painted and does not contribute to the historical or architectural continuity of the district. (314 Randall Avenue)
63. Pinon Tree Cafe - another converted concrete block building, which is of the same unimaginative construction as the Service Center, painting is also not copacetic with the character of the district. (312 Randall Avenue)
99. VanSchaak Realty - a remodeled Plains House, the character of which has been severly violated by the addition of a mansard roof of shake shingles, stucco, and colonial details such as shutters and broken pediment over the door. The integrity of this building could possibly be restored at considerable expense. (100 E. 26th Street)

**United States Department of the Interior
Heritage Conservation and Recreation Service**

**National Register of Historic Places
Inventory—Nomination Form**

For HCRS use only

received

date entered

DEC 10 1978

Continuation sheet Significance-Addendum

Item number 8

Page 1

Gilchrist Park is a triangular plot of ground bounded on the west by Pioneer Avenue, on the south by 26th Street, and on the northeast by Randall Avenue, just west of the intersection of Carey and Randall Avenues.

Located in the park stands a memorial to Robert Burns. The statue itself, a bronze image of Burns, attired in the costume typical of his times, stands 6½ feet high on a pedestal of Georgia gray granite 12½ feet high. The statue was prepared by noted Scottish sculptor Henry S. Gamely. Mr. Gamely was known internationally for his studies of Burns and others done in both bronze and marble.

Funds for establishing the park and statue were donated by longtime Cheyenne resident, Mary Gilchrist. The park was donated and established in 1926 in memory of Mrs. Gilchrist's husband Andrew. Andrew Gilchrist was an early Cheyenne pioneer. Arriving in 1877, he made a fortune on the cattle industry and then established the Stockgrowers National Bank. Mr. Gilchrist later served in the territorial legislature and was very active in the community for many years.

Burns was a favorite of Mary Gilchrist and she had the statue constructed in the park, "so that passers-by might pause and spend a quiet moment contemplating his gentle philosophies". The statue was dedicated in 1929 and is reputed to be the first of its character erected in Wyoming.

Just east of the park, on a tiny triangular plot, stands the Holliday Memorial. This shaft originally served as a light for the park area and plans are underway by the neighborhood to have it put back into use. The shaft was erected early in the 1920's by Mr. and Mrs. Cal Holliday in memory of their son. The Hollidays' were prominent citizens involved in a variety of civic activities, the most outstanding of which was their donation of land and monies for the establishment of Holliday City Park. Mr. Holliday served as Park Commissioner for many years and later as mayor. The shaft stands approximately 15 feet high on a concrete base.

Both memorials were erected on small plots of ground resulting from the diagonal cutting of Randall Avenue. Both deserve inclusion within the district. Gilchrist Park has long been the only park in the neighborhood and is used by many residents of the area. The Holliday Memorial, though not used by the neighborhood in the same way as the park, serves as a gateway to the neighborhood and like Gilchrist Park contributes to the sense of time and place that is evident throughout the neighborhood.

**United States Department of the Interior
Heritage Conservation and Recreation Service
National Register of Historic Places
Inventory—Nomination Form**

For HCRS use only

received

date entered

DEC 10 1980

Continuation sheet Significance-Addendum

Item number 8

Page 2

REFERENCESRESEARCH

Wyoming State Archives, Museums and Historical Department. Cheyenne, Wyoming; H72-14
Mrs. Marshall Reynolds Collection.

INTERVIEWS

Telephone interview with City Engineers Office, City of Cheyenne, Cheyenne, Wyoming.
October, 1979. (records search).

Telephone interview with City Parks and Recreation Office, City of Cheyenne, Cheyenne,
Wyoming. October, 1979. (records search).

UNITED STATES DEPARTMENT OF THE INTERIOR
NATIONAL PARK SERVICE

FOR NPS USE ONLY	
RECEIVED	SEP 16 1980
DATE ENTERED	

**NATIONAL REGISTER OF HISTORIC PLACES
INVENTORY -- NOMINATION FORM**

CONTINUATION SHEET

ITEM NUMBER 9 PAGE twenty-four

Larson, T.A., History of Wyoming. Lincoln: University of Nebraska Press, 1965.

Centennial Historic Committee. Cheyenne, Magic City of the Plains. Cheyenne: Cheyenne Litho Inc., 1967.

Dubois, William, James Eherenberger and Robert R. Larson. Cheyenne Landmarks 1976. Cheyenne: Laramie County Chapter of the Wyoming State Historical Society, 1976.

Wyoming State Historical Society, Laramie County Chapter. "Cheyenne Landmarks, 1976." Cheyenne: Pioneer Printing and Stationary Company, 1976.

Lois Batalden Hansen. "A Brief History of Cheyenne, Wyoming." Unpublished paper, April, 1975.

Abstracts of Title to Property--Located in Cheyenne--Laramie County Building, County Clerk's Office. All of Blocks 18, 19, 20, 44, 45, 46, 47, 78, 79, 80, 81, & 109, Original City of Cheyenne.

UNITED STATES DEPARTMENT OF THE INTERIOR
NATIONAL PARK SERVICE

FOR NPS USE ONLY	
RECEIVED	DEC 10 1974
DATE ENTERED	

**NATIONAL REGISTER OF HISTORIC PLACES
INVENTORY -- NOMINATION FORM**

CONTINUATION SHEET

ITEM NUMBER 10 PAGE twenty-five

the northern boundary. Warren Avenue is a primary arterial historically and currently, a major boundary. Warren is also the north south dividing line of two other proposed historic districts to the east of Capitol North. The southern boundary, 26th Street, abuts contemporary state building expansion. The western edge of the district is heavily intruded by commercial development and state expansion.

UNITED STATES DEPARTMENT OF THE INTERIOR
NATIONAL PARK SERVICE

FOR NPS USE ONLY	
RECEIVED	SEP 16 1980
DATE ENTERED	0 16 80

**NATIONAL REGISTER OF HISTORIC PLACES
INVENTORY -- NOMINATION FORM**

CONTINUATION SHEET

ITEM NUMBER 10A PAGE twenty-six

<u>POINT</u>	<u>ZONE</u>	<u>EASTING</u>	<u>NORTHING</u>
I	13	516860	4554340
J	13	516800	4554220

CAPITOL NORTH HISTORIC DISTRICT

VICINITY MAP

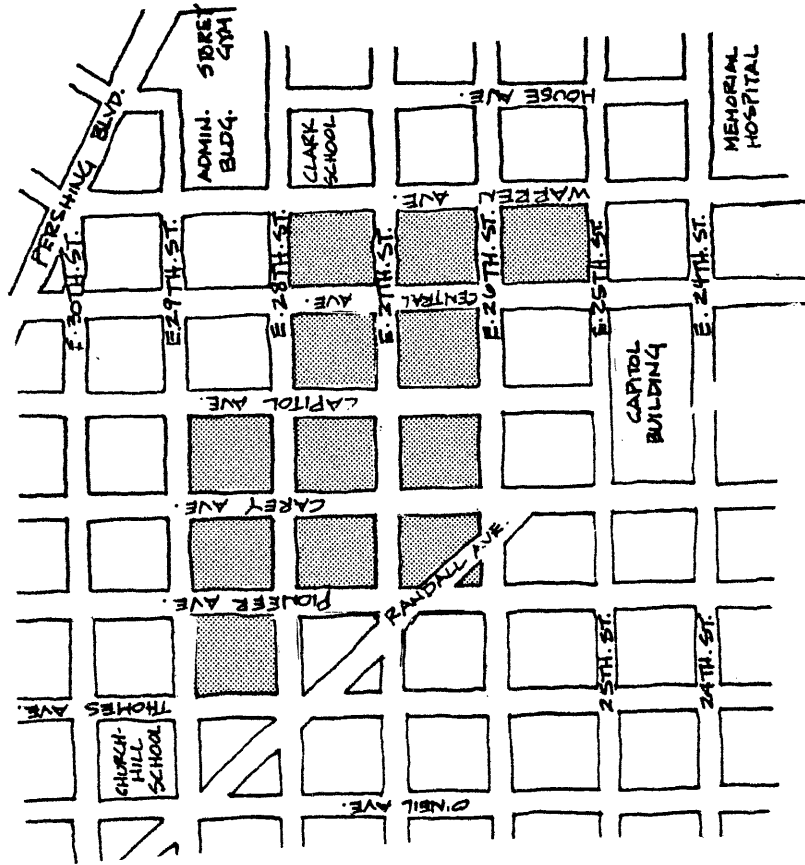

SEP 16 1980

CAPITOL NORTH HISTORIC DISTRICT

BUILDING IDENTIFICATION

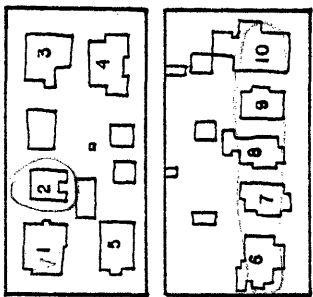
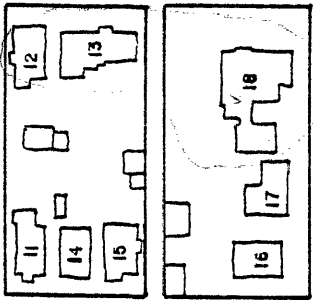
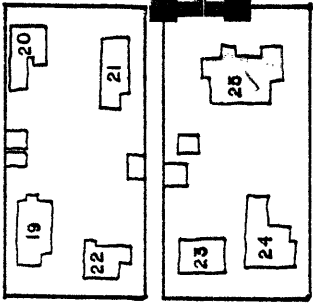

28th Street

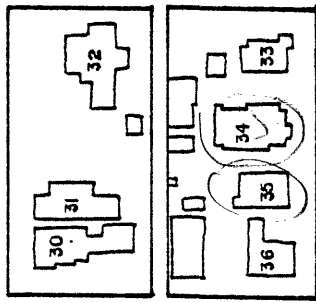

Corey Avenue

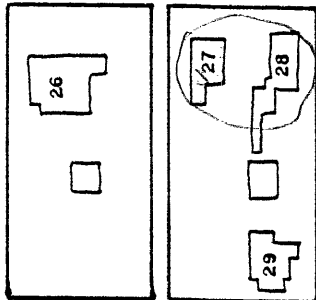

Pioneer Avenue

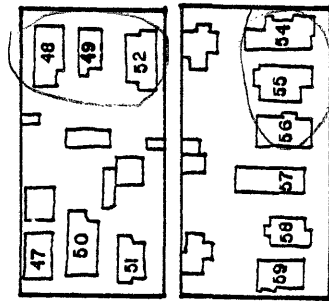

Avenue

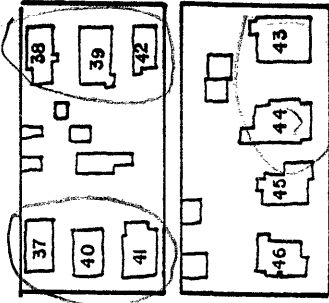

Capitol Avenue

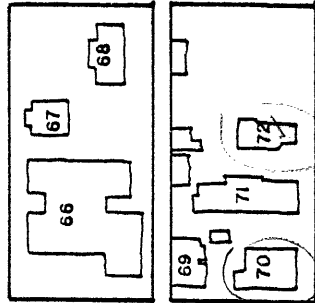

27th Street

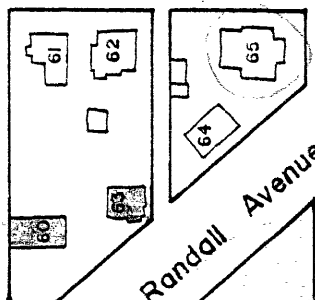

Randall Avenue
Gilcrest park

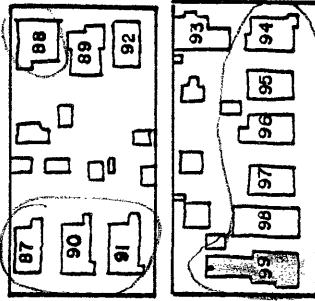

Central Avenue

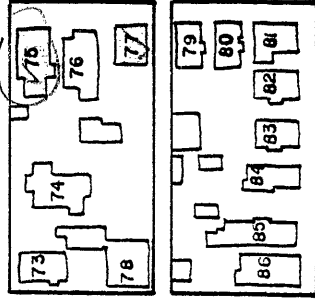

26th Street

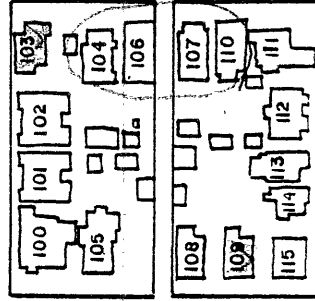

memorial shaft

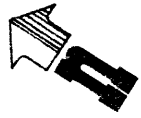

SEP 16 1980

CAPITOL NORTH HISTORIC DISTRICT

PHOTO VIEWPOINTS

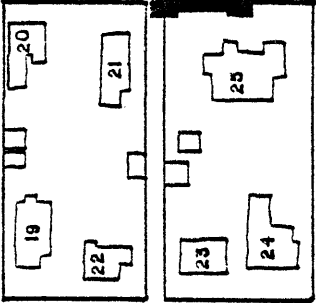
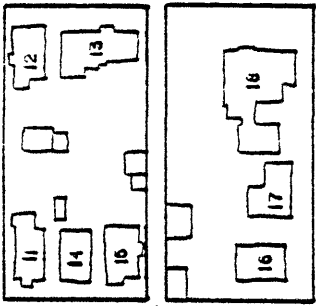
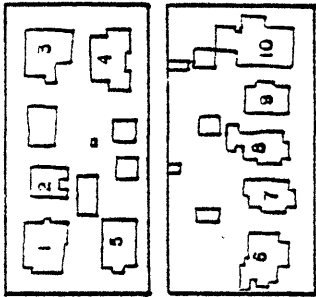

28th Street

Pioneer Avenue

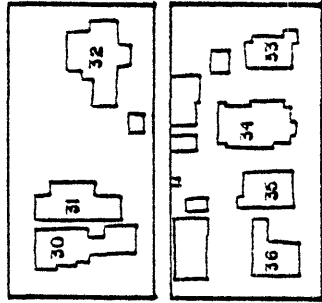
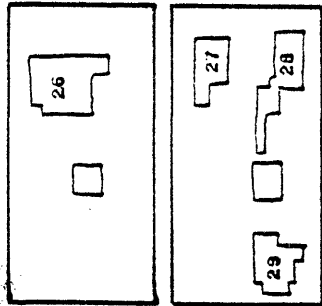

Carey Avenue

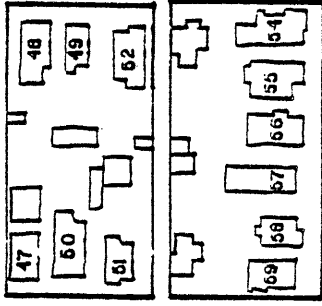
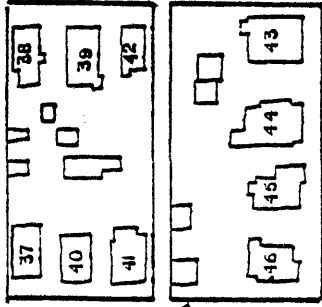

Central Avenue

27th Street

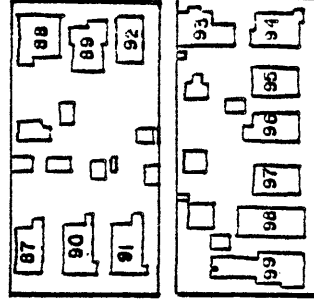
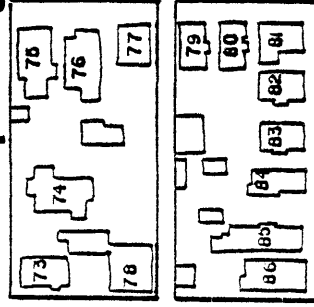
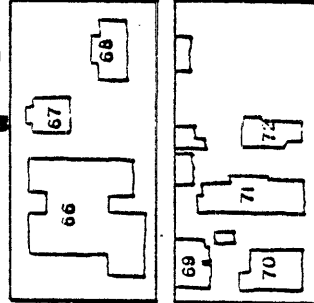
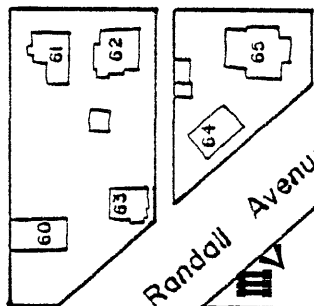

26th Street

memorial shaft

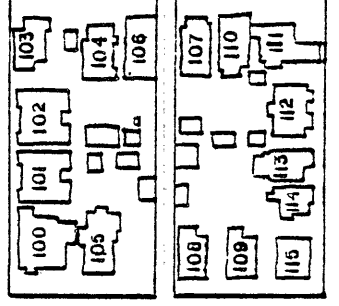

Randall Avenue
gilcrest park

